



Catalog Number	
Project	Type

FEATURES & SPECIFICATIONS

APPLICATION — This fixture is designed for suspension mounting for direct/indirect applications where aesthetics and performance are both needed. Virtually glare free and shadow free illumination.

CONSTRUCTION — Heavy gauge roll formed steel housing with optional perforated pattern and standard center louvers. Units are shipped with die cast aluminum joiners installed for suspension and structural continuity. Designed to mount on exact 4 foot, 8 foot, and 12 foot centers. Joiners will accept stems, single cable, and power cords as supplied by Horizon. Two die cast aluminum architectural ends available (Spade, Bull Nose). Optional lamp sleeves are available that allow for the adjustment of the up/down light produced by the fixture (order one per lamp).

FINISH — All reflective surfaces are finished with a high reflectance, lighting fixture white polyester powder. Special finishes available upon request.

OPTICAL SYSTEM — The direct/indirect lighting configuration provides ample downlight for tasks or general illumination while providing an aesthetically pleasing uplight to brighten spaces and eliminate the “cave” effect.

ELECTRICAL SYSTEM — ETL listed. Suitable for damp locations. Damp location emergency pack must be specified separately. Ballasts are solid-state electronic. Ballasts and lamp holders are replaceable without removing from ceiling. Discrete voltage must be specified for emergency pack options when wired with flex.



Louvered / Perforated Linear LPL SERIES

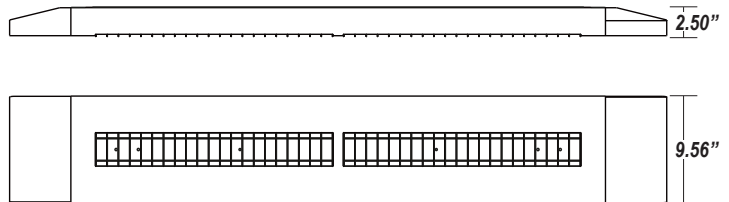
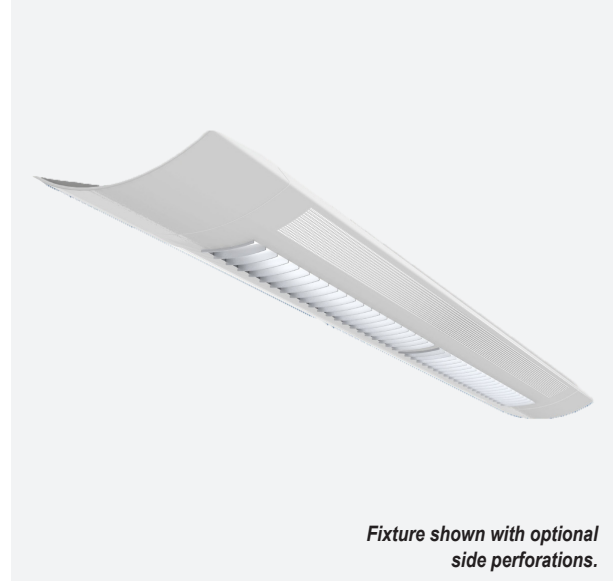

Series	Housing Height	Width
LPL	2.50"	9.56"

ORDERING INFORMATION

Choose the bold face options for the appropriate luminaire configuration for your application and enter on the line above each fixture attribute. Accessories may be factory installed, depending on the particular accessory chosen, but still be ordered as a separate line item.

Example: **LPL232D**

Series	Lamps	Wattage / Type	Finish	Side Perforations	Voltage	Ballast Factor	Fixture Type
LPL	2	32 32W T8, 48"	Blank White	Blank None	D Multi-Volt ²	Blank Normal	Blank Stand Alone Unit
	3	54 54W T5HO, 46"	T Titanium	P Perforated		H High	ER End of Run
			B Black			L Low	BR Beginning of Run
			SP Special ¹				I Intermediate

For tandem double-length unit, add suffix T
Ex: LPLT
(This is the number of lamps per cross section. Tandem fixture bodies will have two cross sections per fixture doubling the length and number of lamps per fixture)

Options (Order as separate line items)

P Program Start	WH34 Wiring Harness 3-Wire 4-Foot
FBF Fast-Blow Fuse	WH44 Wiring Harness 4-Wire 4-Foot
SBF Slow-Blow Fuse	WH54 Wiring Harness 5-Wire 4-Foot
EB5 500 Lumen Emergency Ballast	WH38 Wiring Harness 3-Wire 8-Foot
EB7 700 Lumen Emergency Ballast	WH48 Wiring Harness 4-Wire 8-Foot
EB14 1400 Lumen Emergency Ballast	WH58 Wiring Harness 5-Wire 8-Foot
EB30 3000 Lumen Emergency Ballast	
LDT5 T5 Lamp Sleeve (one)	
LDT8 T8 Lamp Sleeve (one)	

NOTES

- 1 Custom RAL color matching is available at an additional cost. Contact your Techlight sale representative for additional information.
- 2 Multi-Volt is 120/277V.

LPL Louvered / Perforated Linear

END CAPS

The Horizon Slotted Linear fixture was designed to be mounted as either a stand-alone fixture, or mounted end-to-end for continuous linear rows. The mounting configuration will determine the number of end caps and joiner plates needed to complete an installation.

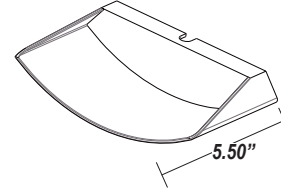

End Caps should be ordered 2 per fixture for stand-alone fixtures or 2 per row for continuous linear rows (# of fixtures x 2, or # of rows x 2). Joiner Plates should be ordered as 1 per the number of fixtures in each row minus 1 (# of fixtures per row minus one)

Part Number	Description
SE	Scoop End Cap (one)

PENDANTS

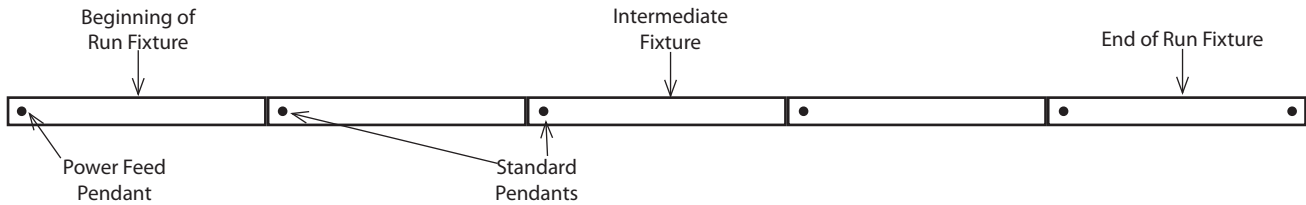

A mounting pendant is needed for the beginning of each row, for each connection point in a continuous row and for the end of each row. Custom pendant lengths may be available upon request.

Pendants		Length ²	
PMNW	<i>Rigid Pendant¹</i>	12	<i>Rigid</i> 12"
CPNW	<i>Aircraft Cable Pendant No Power Feed</i>	18	18"
CPWW	<i>Aircraft Cable Pendant With Power Feed Wireway</i>	24	24"
		50	<i>Aircraft Cable³</i> 50"
		100	100"
		150	150"
		200	200"

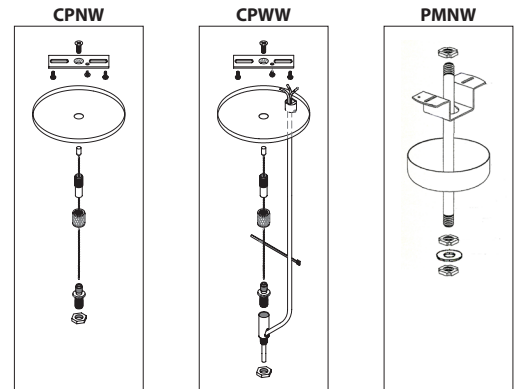

Typical Row Configurations

	Approx Row Length	4'	8'	12'	16'	20'	24'	28'	32'	36'	40'	44'	48'
Fixture Length	4'	1		1		1		1		1		1	
	8'		1	1	2	2	3	3	4	4	5	5	6
Power Feed Pendant		1	1	1	1	1	1	1	1	1	1	1	1
Non-Power Pendant		1	1	2	2	3	3	4	4	5	5	6	6
End Caps		2	2	2	2	2	2	2	2	2	2	2	2

NOTES

- ¹ Rigid pendant may be used as a power feed.
- ² All pendant lengths are order in inches. Custom lengths available upon request.
- ³ Aircraft cable pendants may be field cut for custom lengths. Specific lengths available over 200" available upon request.

LPL Louvered / Perforated Linear

FIXTURE DIMENSIONS

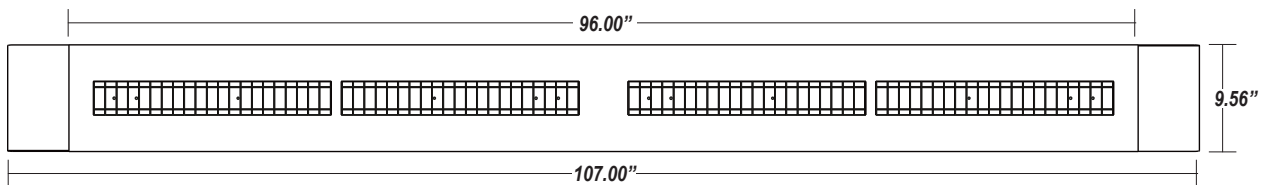
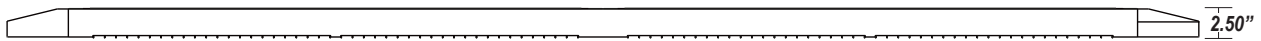
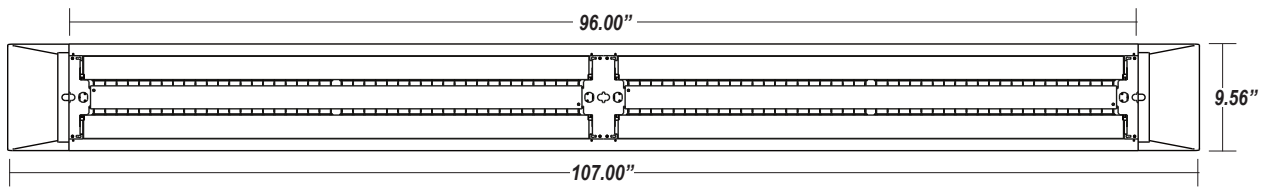
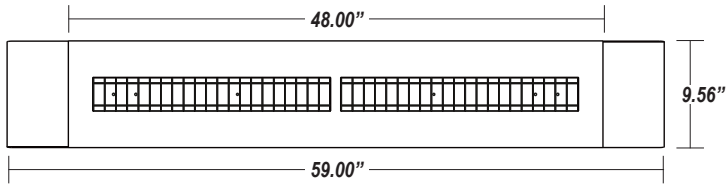
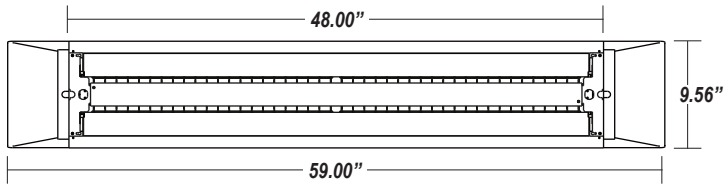

Horizon Linear Lighting
2707 Satsuma Drive
Dallas, TX, 75229
Phone: 214-350-0591, 800-225-0727, Fax: 214-350-9137
www.horizonlightingllc.com