

Install driver housing cover after supply connections are made



Install grounded hub nut



Install driver housing onto threaded hub

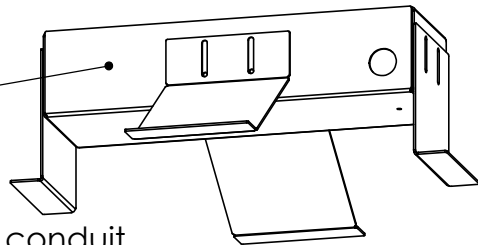

Install hub onto all thread conduit after mounting LED fixture



O-ring

Compression plate with smaller inner hole

These components to be installed for mounting **Driver housing**

These components to be installed for mounting **LED fixture**

Red silicone gasket

Drill 7/8" hole for primary mounting

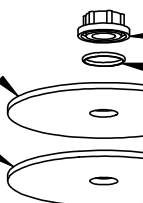

Threaded through hub

O-ring

Housing spacer plate with larger inner hole

Canopy ceiling

Wrap bottom of all thread with Teflon tape for sealing nut threads

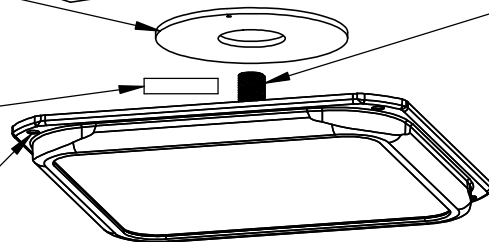

All thread conduit entry for primary mounting. DO NOT REMOVE from fixture housing. This component bonded and wires are potted internally to housing from factory.

4 Screw locations are optional for mounting. If used, seal in place with silicone top and bottom.

Petroleum Canopy Fixture Installation

Use the exploded view and install fixture assembly from bottom to top.

Step 1: Drill a 7/8" hole in Canopy ceiling for primary mounting.

Step 2: Assemble the fixture as shown for mounting **LED fixture**.

Step 3: Assemble the **Driver housing** as shown.

Step 4: Connect driver output leads to LED Fixture and make supply wire connections.

Step 5: Install driver housing cover.

TECHLIGHTUSA.COM

PROPRIETARY AND CONFIDENTIAL

THE INFORMATION CONTAINED IN THIS DRAWING IS THE SOLE PROPERTY OF WWW.TECHLIGHTUSA.COM. ANY REPRODUCTION IN PART OR AS A WHOLE WITHOUT THE WRITTEN PERMISSION OF WWW.TECHLIGHTUSA.COM IS PROHIBITED.



DIMENSIONS ARE IN INCHES

MATERIAL AS SUPPLIED

FINISH CLEAN

CREATED	NAME	DATE
DJM	DJM	7/15/2015

MODIFIED	XXX
ENG APPR.	DJM

INSTALLATION INSTRUCTIONS FOR PETROLEUM CANOPY FIXTURE NEW INSTALLATION

SIZE	DWG. NO.	REV.
A	PTCNP-New Installation	0

DO NOT SCALE DRAWING

SCALE:1:12 WEIGHT: 14.31 lbs

SHEET 1 OF 1