



Catalog Number

Project

Type

## Features & Specifications

### Application

The E93V Surface Mount Luminaire is a classically styled fixture fit for any interior. They are designed to be surface mounted. This fixture is ideal for offices, libraries, schools, etc.

### Features

The fixture is a direct light fixture. The fixture is ideal for direct general illumination with no glare and an aesthetically pleasing housing. Provided with a parabolic aluminum louver.

### Construction

The housing is constructed of rigid extruded aluminum to provide a light weight load to walls. Fixtures can be individually mounted or installed in a continuous row.

### Electrical System

120/277 volt, 50/60 Hz. 480/347 volt available upon request. Comes standard with instant start electronic ballast for T8 applications.

### Finish

Post painted housing and components with a Lighting White Polyester type paint which has a UV stabilizer included with a 93% reflectivity. Raw steel goes through our custom wash system with a mild solvent and pre treatment "rust inhibitor" before passing through a preheat oven. After the paint is applied the fixture then passes through the cure oven for maximum adhesion. Each fixture is painted to a minimum of 2-3 mil thickness for extra durability.

## ECLIPSE SERIES

### E93V SURFACE MOUNT LUMINAIRE

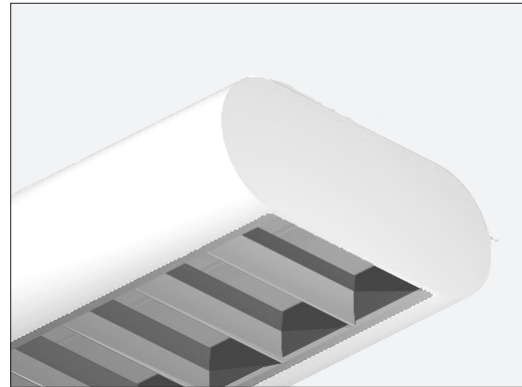

### DIMENSIONS

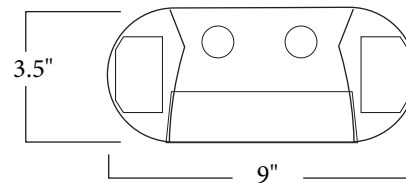

Please contact your Horizon Sales Representative for more information.

All dimensions subject to change without notice.

### Ordering Nomenclature

Ex: (E93V Surface, 2 Lamp, F32T8, White Finish, Louvered, Stand-Alone Unit, Multi-Volt = E93V232D)

--	--	--	--	--	--	--	--

SERIES	NUMBER OF LAMPS PER CROSS SECTION	WATTAGE/TYPE	FIXTURE COLOR	VOLTAGE	BALLAST FACTOR	FIXTURE TYPE	OPTIONS
<b>E93V</b>	<b>2</b> (Tandem fixture bodies will have two cross sections per fixture doubling the length and number of lamps per fixture)	14 - 14W T5, 22" 17 - 17W T8, 24" 24 - 24W T5ho, 22" 28T5 - 28W T5, 46" 28T8 - 28W T8, 48" 32 - 32W T8, 48" 48HO - 60W 800mA, 48" 54 - 54W T5HO, 46"	BLANK - White T - Titanium B - Black SP - Special	D - Multi-Volt 1 - 120V 2 - 277V 3 - 347V 4 - 480V  *Multi-Volt is 120/277V	BLANK - Normal H - High L - Low	BLANK - Stand Alone Unit ER - End of Run BR - Beginning of run BR - Intermediate	P - Program Start EB5 - 500 Lumen Emergency Ballast EB7 - 700 Lumen Emergency Ballast EB14 - 1400 Lumen Emergency Ballast EB30 - 3000 Lumen Emergency Ballast FBF - Fast-Blow Fuse SBF - Slow-Blow Fuse WH34- Wiring Harness 3-Wire 4-Foot WH44- Wiring Harness 4-Wire 4-Foot WH54- Wiring Harness 5-Wire 4-Foot WH38- Wiring Harness 3-Wire 8-Foot WH48- Wiring Harness 4-Wire 8-Foot WH58- Wiring Harness 5-Wire 8-Foot

### ROW LENGTH INFORMATION

To aid in determining the correct bill of material for your order. Please list the row length on the purchase order as such:

Row Length = 16 feet

For multiple rows please list out the individual row lengths for each row as such:

Row 1 = 16 feet

Row 2 = 20 feet



**ECLIPSE SERIES**  
**E93V SURFACE MOUNT LUMINAIRE**

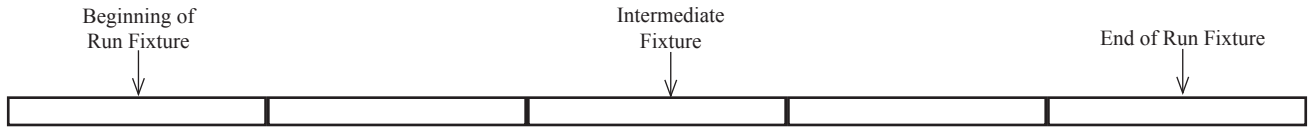

**Typical Row Configurations**

	Row Length	2'	4'	6'	8'	10'	12'	14'	16'	18'	20'	22'	24'	26'	28'	30'	32'	34'	36'	38'	40'	42'	44'	46'	48'
Fixture Length	2'	1		1		1		1		1		1		1		1		1		1		1		1	
	4'		1	1			1	1			1	1			1	1			1	1			1	1	
	8'				1	1	1	1	2	2	2	2	3	3	3	3	4	4	4	4	5	5	5	5	6